



TECHNICAL SPECIFICATION SHEET



100MM INLINE MIXED FLOW FAN

477638

100mm Inline mixed flow fan plus timer with LED shower and light kit.

Key features:

- Integral foot plate provides secure, fast mounting
- Spigot designed for speedy installation of flexible ducting
- Mixed flow fans develop greater pressure than conventional axial fans making them ideal for use in ducted systems
- 3 Speed fan setting

Technical specification:

- Fully Building Code Compliant
- IPX4 rated CE marked in accordance with all the relevant EEC Harmonised Directives
- Double Insulated with motor fitted with Thermal Protection

Product range details:

- Rated Voltage 220-240v-50Hz
- High Rated Wattage 48W
- Low Rated Wattage 28W
- High Speed Noise Level: 35dB(A) @ 3m
- Low Speed Noise Level 21dB(A) @ 3m
- High Speed: 500m³/h
- Low Speed: 240m³/h

Accessories:

- Wall Kit
- External wall grille
- Flexible Ducting
- Diameter of spigot: 98mm

LED shower and light kit

Key features:

- SFP down to 0.43W/l/s
- Incorporates an integral adjustable electronic timer (1-20 mins)
- Quiet Operation
- Limited to 1.5m of ducting when connected to an axial fan

Technical specification:

- Meets the requirements of Building Regulation Document F and L
- IP44 rated
- CE marked in accordance with all the relevant EEC Harmonised Directives
- Double Insulated, class II
- Motor fitted with thermal protection
- Airflow: Maximum 24 lts/sec

Product range details:

- Rated Voltage: 220-240V 50Hz
- Rated Power: 10.4W
- Maximum Pressure: 20 p.a.
- Sound Volume- 41dB(A)
- Maximum Operating Temperature: 40°C

Specific Fan Power

(SFP) Requirements:

1.0 a. Mechanical ventilation systems should be designed to minimise electric fan power. Specific fan power (SFP) should not be worse than:

i. 0.5 Watts per litres per seconds for intermittent extract ventilation systems

ii. 0.7 Watts per litres per seconds for continuous extract ventilation systems

iii. 1.5 Watts per litres per seconds for continuous supply and extract with heat recovery ventilation systems

Dimensions:

Product	A	B	C	D
1	140mm			
1a	Ø98mm	33mm	15mm	
2	Ø140mm	10mm	62mm	Ø98mm
3	Ø102mm	195mm	298mm	30mm

1

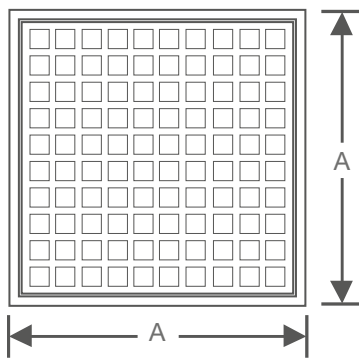

1a

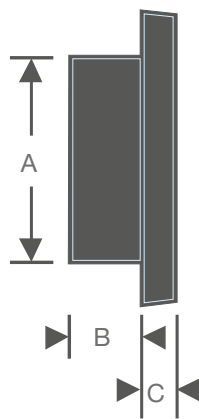

2

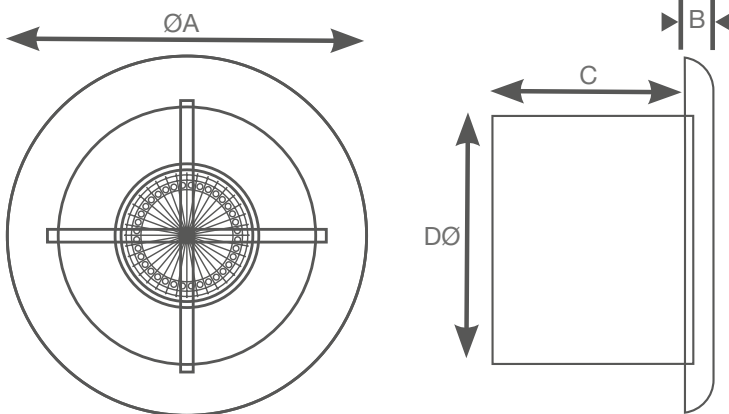

3

